

Fontaine Fifth Wheel Cylinder Valve Replacement

Air actuated Fontaine Fifth Wheel models feature an air cylinder for cab release. **It is very important that a cylinder valve is functioning properly, especially in cold weather.**

A kit is available for cylinder component repair or retrofiting.

Part number (Left Driver Side Handle): **KIT-AA-6000L**.

However, sometimes you may need to replace just the valve.

Fontaine recommends using the Clippard **JEV-F4M4**.

This part and others like it are readily available at multiple parts distribution stores. See valve specs below.

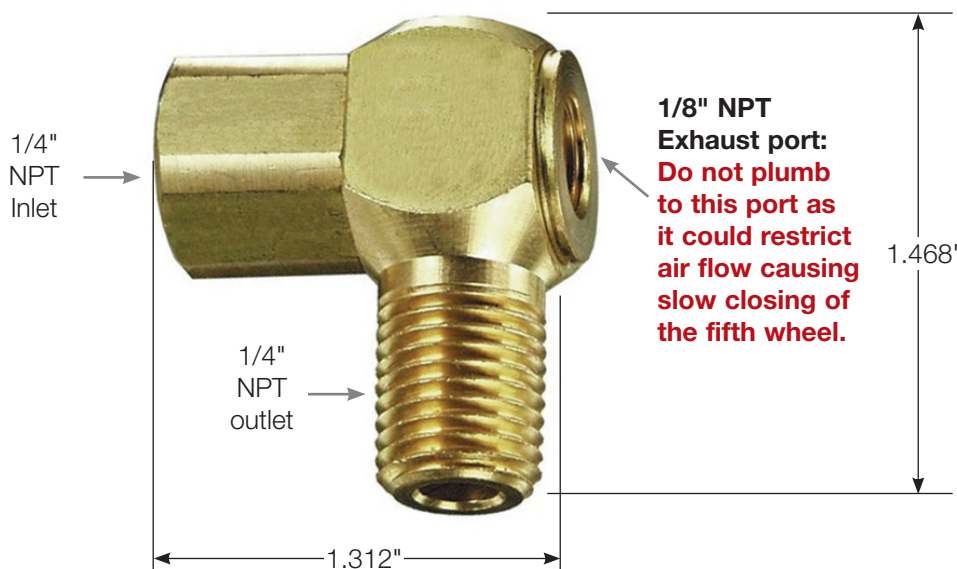

- 15 to 150 psig maximum
- Male outlet offers direct connection to cylinder
- 36 scfm @ 50 psig and 58 scfm @ 100 psig
- Brass construction with molded Nitrile seal

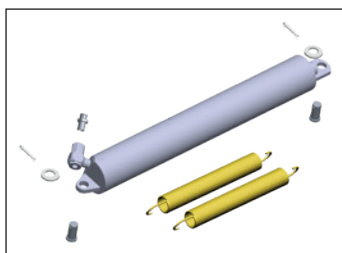

No-Slack® **KIT-AA-6000L**
currently includes the
JEV-F4M4 valve.